

# MAGNETIC BASE DRILL

## HF-50

ORDER CODE: (D9508)

EDITION : 1.0  
DATE: (11/24)

The following section covers the spare parts diagrams and lists that were current at the time this manual was originally printed. Due to continuous improvements of the machine, changes may be made at anytime without notification.

### HOW TO ORDER SPARE PARTS

1. Have your machines model number, serial number & date of manufacture on hand, these can be found on the specification plate mounted on the machine.
2. A scanned copy of your parts list/diagram with required spare part/s identified.

#### NOTE: SOME PARTS MAY ONLY BE AVAILABLE AS AN ASSEMBLY

3. Go to [www.machineryhouse.com.au/contactus](http://www.machineryhouse.com.au/contactus) and fill out the inquiry form attaching a copy of scanned parts list.

**WARNING!**

*Electricity is dangerous and could cause death.  
All electrical work must be carried out by a qualified electrician.*

**CAUTION**

*It is impossible to cover all possible hazards Every workshop environment is different. These are designed as a guide to be used to compliment training and as a reminder to users prior to equipment use. Always consider safety first, as it applies to the individual working conditions.*

## SPARE PARTS DIAGRAM (HF-50)

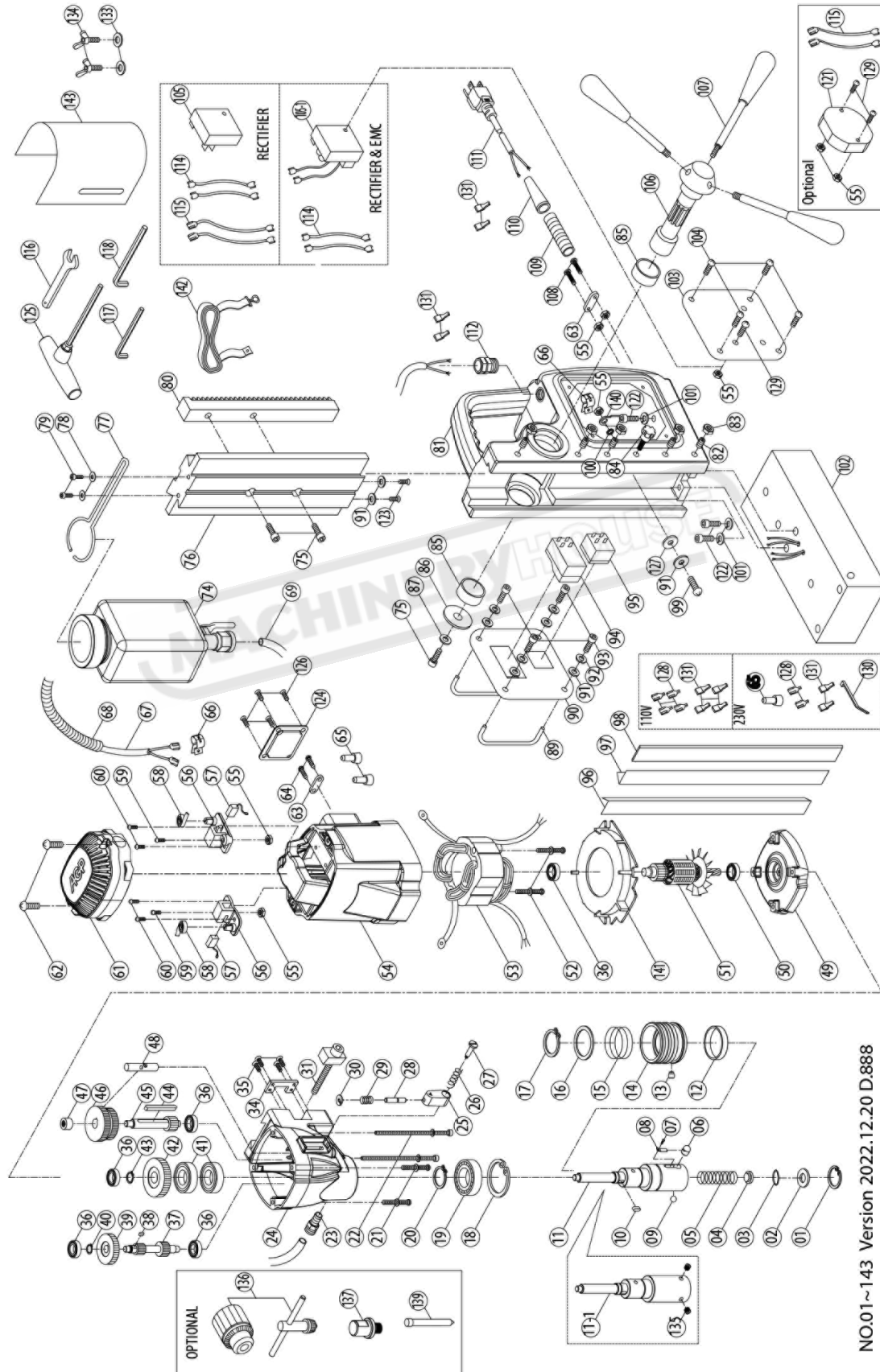

NO.01~143 Version 2022.12.20 D.888

## SPARE PARTS LIST

Item	Description	Qty	Item	Description	Qty.
1	INTERNAL CIRCLIP (R-19)	1	57	CARBON BRUSH (7x11x17)	2
2	FLAT WASHER (Ø10xØ18.5x0.8)	1	58	BRUSH SPRING (0.35x3x3T)	2
3	O-RING (Ø12x4)	1	59	PANHEAD MACHINE SCREW (M4x10xP0.7)	2
4	WATER SEAL (Ø12x15)	1	60	PANHEAD TAPPING SCREW (M4x12)	4
5	SPRING (Ø1.2xØ10.1xØ12.5x12Tx85L)	1	61	MOTOR TAIL CASTING	1
6	LOCK PIN (12.3MM)/(11.7MM)	1	62	PANHEAD TAPPING SCREW (M4x25)	2
7	PANHEAD MACHINE SCREW (M3x4xP0.5)	1	63	CABLE CLIP	2
8	LOCK PIN SPRING	1	64	PANHEAD TAPPING SCREW (M4x14)	2
9	CHECK BALL (Ø8)	1	65	CRIMP CAP CONNECTOR (C4)	3
10	PARALLEL KEY (5x5x10)	1	66	CABLE CLAMP	2
11	SPINDLE (194.5MM)	1	67	WIRE (1.25x2Cx65CM-VCTF)	1
11-1	SPINDLE	1	68	CABLE PROTECTOR (5/16"x40CM)	1
12	RING (Ø40xØ44x9)	1	69	TUBE (Ø4xØ6x20CM)	1
13	COLLAR PIN (Ø8)	1	74	COOLANT TANK ASSEMBLY	1
14	QUICK-RELEASE COLLAR	1	75	SOCKET CAP SCREW (M6x16xP1.0)	3
15	SPRING (Ø2.3xØ39xØ43.6x3Tx30L)	1	76	SLIDE PLATE (L217MM)	1
16	SPRING SEAT RING (Ø35.1xØ44.5x2)	1	77	COOLANT TANK BRACKET	1
17	EXTERNAL CIRCLIP (S-35)	1	78	FLAT WASHER (Ø5xØ12x1)	2
18	INTERNAL CIRCLIP (R-47)	1	79	SOCKET CAP SCREW (M5x16xP0.8)	2
19	BALL BEARING (6005)	1	80	GEAR RACK (M1.5x150L)	1
20	EXTERNAL CIRCLIP (S-25)	1	81	STAND BODY	1
21	PANHEAD TAPPING SCREW (M5x65)	2	82	SOCKET SET SCREW (M5x20xP0.8)	5
22	PANHEAD TAPPING SCREW (M5x110)	2	83	HEX NUT (M5xP0.8)	5
23	PUSH LOCK FITTING (PT1/8"xØ6)	1	84	THUMB SCREW (M5x16)	1
24	GEAR HOUSING	1	85	BUSHING (Ø28xØ32x12)	2
25	SELECTOR TAB	1	86	FLAT WASHER (Ø6xØ40x2.5)	1
26	SPRING (Ø1xØ9xØ11x11Lx4T)	1	87	FLAT WASHER (Ø6xØ25x1)	1
27	SHOULDER SCREW	1	89	SWITCH GUARD BAR (90MM)	2
28	DETENT PIN (Ø5x22)	1	90	SWITCH PANEL (90x110x1.5T)	1
29	SPRING (Ø0.6xØ5.3xØ6.5x17Lx5T)	1	91	FLAT WASHER (Ø4xØ10x1)	7
30	E-CLIP (E-3)	1	92	SPRING WASHER (M4)	4
31	SLIDE HEIGHT LOCK	1	93	SOCKET CAP SCREW (M4x16xP0.7)	4
34	LOCK BRACKET	1	94	MOTOR SWITCH (110V/220V)	1
35	FLAT HEAD MACHINE SCREW (M4x10xP0.7)	4	95	MAGNET SWITCH (110V&220V)	1
36	BALL BEARING (608)	5	96	GIB STRIP-LEFT (258MM)	1
37	INPUT SHAFT (M1.0x12Tx17T)	1	97	GIB STRIP-RIGHT (258MM)	1
38	PARALLEL KEY (4x4x8)	1	98	GIB TENSIONER (258x11x1.2T)	1
39	INPUT GEAR (M1.0x36T)	1	99	PANHEAD MACHINE SCREW (M4x16xP0.7)	1
40	EXTERNAL CIRCLIP (S10)	1	100	EXTERNAL STAR WASHER (M5)	1
41	OIL SEAL (Ø25xØ40x7)	2	101	SPRING WASHER (M6)	3
42	OUTPUT GEAR (M1.25x37T)	1	102	ELECTROMAGNET (164x80x48)	1
43	EXTERNAL CIRCLIP (S-15)	1	103	SIDE PANEL (110x90x1.5T)	1
44	PARALLEL KEY (5x5x50)	1	104	PANHEAD MACHINE SCREW (M4x8xP0.7)	4
45	COUNTERSHAFT (M1.25x12T)	1	105	RECTIFIER (110&220V)	1
46	LAY GEAR (M1.0x45Tx40T)	1	105-1	RECTIFIER & EMC (110V)/(110V&220V)	1
47	NEEDLE BEARING (HK 0810)	1	106	CRANK SPINDLE (Ø28)	1
48	SELECTOR FORK (Ø10x50 / Ø4.8x26)	1	107	CRANK HANDLE	3
49	GEAR PLATE	1	108	PANHEAD MACHINE SCREW (M4x30xP0.7)	2
50	BALL BEARING (6001)	1	109	CABLE PROTECTOR (5/16"x7CM)	1
51	ARMATURE (110V/220V-73x42x45)	1	110	CORD ARMOR	1
52	PANHEAD TAPPING SCREW (M5x60)	2	111	POWER SUPPLY CABLE	1
53	STATOR (110V/220V-73x42x45)	1	112	CABLE GLAND (5/16")	1
54	MOTOR HOUSING	1	114	WIRE LEAD (1015-16#18CM)	2
55	HEX NUT (M4xP0.7)	8	115	WIRE LEAD (1015-16#18CM)	4
56	CARBON BRUSH HOLDER (7x11)	2	116	COMBINATION WRENCH (M8)	1

## SPARE PARTS LIST

Item	Description	Qty	Item	Description	Qty.
117	HEX KEY (M2.5)	1	133	FLAT WASHER (Ø6xØ13x1)	2
118	HEX KEY (M4)	1	134	BUTTERFLY SCREW (M6x10xP1.0)	2
121	OVER LOAD PROTECTION (110V/220V)	1	135	SOCKET SET SCREW (M8x7xP1.25)	2
122	SOCKET CAP SCREW (M6x20xP1.0)	3	136	CHUCK (1/2")	1
123	TRUSS HEAD MACHINE SCREW (M4x6xP0.7)	2	137	QUICK-RELEASE CHUCK ADAPTORS (1/2')	1
124	MOTOR COVER PLATE	1	139	PILOT PIN (HSSx77LxØ6.34)/(HSSx103LxØ6.34)	1
125	T-HANDLE HEX KEY (M6)	1	139	PILOT PIN (TCTx90LxØ7.98)/(TCTx90LxØ6.34)	1
126	FLAT HEAD TAPPING SCREW (M4x8)	4	139	PILOT PIN (TCTx106LxØ6.34)/(TCTx108LxØ7.98)	1
127	RUBBER WASHER (Ø4xØ11x1)	1	140	EARTHING MARKING	1
128	FEMALE SPADE TERMINAL	4	141	FAN SHROUD	1
129	PANHEAD MACHINE SCREW (M4x25xP0.7)	3	142	SAFETY BELT	1
130	ZIP TIE (2.4x80MM)	1	143	CHIP GUARD	1
131	SPADE TERMINAL BOOT	8			

**NOTE: SOME INDIVIDUAL PARTS MAY ONLY BE AVAILABLE AS AN ASSEMBLY**

## ELECTRICAL

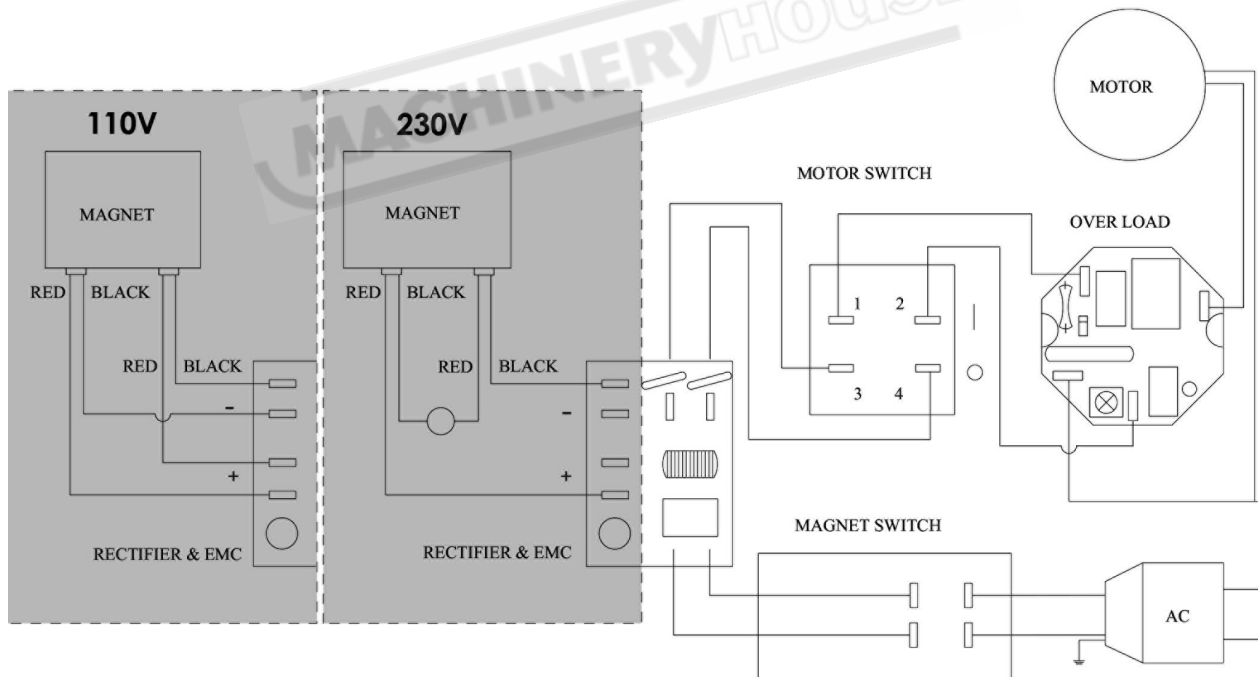

## WARNING

**Always disconnect the power to the machine before servicing or doing maintenance to the machine.**